

Application for a premises licence to be granted under the Licensing Act 2003

PLEASE READ THE FOLLOWING INSTRUCTIONS FIRST

Before completing this form please read the guidance notes at the end of the form. If you are completing this form by hand please write legibly in block capitals. In all cases ensure that your answers are inside the boxes and written in black ink. Use additional sheets if necessary.

You may wish to keep a copy of the completed form for your records.

I/we SABARATNAM KUGANANTHAN

(Insert name(s) of applicant)

apply for a premises licence under section 17 of the Licensing Act 2003 for the premises described in Part 1 below (the premises) and I/we are making this application to you as the relevant licensing authority in accordance with section 12 of the Licensing Act 2003

Part 1 – Premises details

Postal address of premises or, if none, Ordnance Survey map reference or description			
181 CAMBRIDGE STREET			
BUCKINGHAMSHIRE			
Post town	AYLESBURY	Postcode	HP20 1BQ
Telephone number at premises (if any)			
Non-domestic rateable value of premises		£ 250,000	

Part 2 - Applicant details

Please state whether you are applying for a premises licence as **Please tick as appropriate**

- a) an individual or individuals * please complete section (A)
- b) a person other than an individual *
 - i as a limited company/limited liability partnership please complete section (B)
 - ii as a partnership (other than limited liability) please complete section (B)
 - iii as an unincorporated association or please complete section (B)
 - iv other (for example a statutory corporation) please complete section (B)
- c) a recognised club please complete section (B)
- d) a charity please complete section (B)

- e) the proprietor of an educational establishment please complete section (B)
- f) a health service body please complete section (B)
- g) a person who is registered under Part 2 of the Care Standards Act 2000 (c14) in respect of an independent hospital in Wales please complete section (B)
- ga) a person who is registered under Chapter 2 of Part 1 of the Health and Social Care Act 2008 (within the meaning of that Part) in an independent hospital in England please complete section (B)
- h) the chief officer of police of a police force in England and Wales please complete section (B)

* If you are applying as a person described in (a) or (b) please confirm (by ticking yes to one box below):

- I am carrying on or proposing to carry on a business which involves the use of the premises for licensable activities; or
- I am making the application pursuant to a statutory function or
- a function discharged by virtue of Her Majesty's prerogative

(A) INDIVIDUAL APPLICANTS (fill in as applicable)

Mr <input checked="" type="checkbox"/>	Mrs <input type="checkbox"/>	Miss <input type="checkbox"/>	Ms <input type="checkbox"/>	Other Title (for example, Rev)	
Surname KUGIANANTHAN			First names SA BARATNAM		
Date of birth [REDACTED]		I am 18 years old or over <input checked="" type="checkbox"/> Please tick yes			
Nationality [REDACTED]					
Current residential address if different from premises address		[REDACTED]			
Post town [REDACTED]			Postcode [REDACTED]		
Daytime contact telephone number [REDACTED]					
E-mail address (optional) [REDACTED]					
Where applicable (if demonstrating a right to work via the Home Office online right to work checking service), the 9-digit 'share code' provided to the applicant by that service (please see note 15 for information)					

SECOND INDIVIDUAL APPLICANT (if applicable)

Mr <input type="checkbox"/>	Mrs <input type="checkbox"/>	Miss <input type="checkbox"/>	Ms <input type="checkbox"/>	Other Title (for example, Rev)	
Surname			First names		
Date of birth		I am 18 years old or over		<input type="checkbox"/>	Please tick yes
Nationality					
Where applicable (if demonstrating a right to work via the Home Office online right to work checking service), the 9-digit 'share code' provided to the applicant by that service: (please see note 15 for information)					
Current residential address if different from premises address					
Post town				Postcode	
Daytime contact telephone number					
E-mail address (optional)					

(B) OTHER APPLICANTS

Please provide name and registered address of applicant in full. Where appropriate please give any registered number. In the case of a partnership or other joint venture (other than a body corporate), please give the name and address of each party concerned.

Name
Address
Registered number (where applicable)
Description of applicant (for example, partnership, company, unincorporated association etc.)

Telephone number (if any)
E-mail address (optional)

Part 3 Operating Schedule

When do you want the premises licence to start?

DD	MM	YYYY
01	09	2019

If you wish the licence to be valid only for a limited period, when do you want it to end?

DD	MM	YYYY

Please give a general description of the premises (please read guidance note 1)

CONVENIENCE STORE AND OFF-LICENCE

If 5,000 or more people are expected to attend the premises at any one time, please state the number expected to attend.

What licensable activities do you intend to carry on from the premises?

(please see sections 1 and 14 and Schedules 1 and 2 to the Licensing Act 2003)

Provision of regulated entertainment (please read guidance note 2)

Please tick all that apply

- a) plays (if ticking yes, fill in box A)
- b) films (if ticking yes, fill in box B)
- c) indoor sporting events (if ticking yes, fill in box C)
- d) boxing or wrestling entertainment (if ticking yes, fill in box D)
- e) live music (if ticking yes, fill in box E)
- f) recorded music (if ticking yes, fill in box F)
- g) performances of dance (if ticking yes, fill in box G)
- h) anything of a similar description to that falling within (e), (f) or (g) (if ticking yes, fill in box H)

Provision of late night refreshment (if ticking yes, fill in box I)

Supply of alcohol (if ticking yes, fill in box J)

In all cases complete boxes K, L and M

A

Plays Standard days and timings (please read guidance note 7)			<u>Will the performance of a play take place indoors or outdoors or both – please tick</u> (please read guidance note 3)	Indoors	<input type="checkbox"/>
				Outdoors	<input type="checkbox"/>
				Both	<input type="checkbox"/>
Day	Start	Finish	<u>Please give further details here</u> (please read guidance note 4)		
Mon					
Tue			<u>State any seasonal variations for performing plays</u> (please read guidance note 5)		
Wed					
Thur			<u>Non standard timings. Where you intend to use the premises for the performance of plays at different times to those listed in the column on the left, please list</u> (please read guidance note 6)		
Fri					
Sat					
Sun					

B

Films Standard days and timings (please read guidance note 7)			<u>Will the exhibition of films take place indoors or outdoors or both – please tick</u> (please read guidance note 3)	Indoors	<input type="checkbox"/>			
				Outdoors	<input type="checkbox"/>			
				Both	<input type="checkbox"/>			
Day	Start	Finish	<u>Please give further details here</u> (please read guidance note 4)					
Mon								
Tue								
Wed						<u>State any seasonal variations for the exhibition of films</u> (please read guidance note 5)		
Thur								
Fri						<u>Non standard timings. Where you intend to use the premises for the exhibition of films at different times to those listed in the column on the left, please list</u> (please read guidance note 6)		
Sat								
Sun								

C

Indoor sporting events Standard days and timings (please read guidance note 7)			<u>Please give further details</u> (please read guidance note 4)
Day	Start	Finish	
Mon			
Tue			<u>State any seasonal variations for indoor sporting events</u> (please read guidance note 5)
Wed			
Thur			<u>Non standard timings. Where you intend to use the premises for indoor sporting events at different times to those listed in the column on the left, please list</u> (please read guidance note 6)
Fri			
Sat			
Sun			

D

Boxing or wrestling entertainments Standard days and timings (please read guidance note 7)			<u>Will the boxing or wrestling entertainment take place indoors or outdoors or both - please tick</u> (please read guidance note 3)	Indoors	<input type="checkbox"/>
				Outdoors	<input type="checkbox"/>
				Both	<input type="checkbox"/>
Day	Start	Finish			
Mon			<u>Please give further details here</u> (please read guidance note 4)		
Tue					
Wed			<u>State any seasonal variations for boxing or wrestling entertainment</u> (please read guidance note 5)		
Thur					
Fri			<u>Non standard timings. Where you intend to use the premises for boxing or wrestling entertainment at different times to those listed in the column on the left, please list</u> (please read guidance note 6)		
Sat					
Sun					

E

Live music Standard days and timings (please read guidance note 7)			<u>Will the performance of live music take place indoors or outdoors or both -- please tick</u> (please read guidance note 3)	Indoors	<input type="checkbox"/>
				Outdoors	<input type="checkbox"/>
				Both	<input type="checkbox"/>
Day	Start	Finish	<u>Please give further details here</u> (please read guidance note 4)		
Mon					
Tue			<u>State any seasonal variations for the performance of live music</u> (please read guidance note 5)		
Wed					
Thur			<u>Non standard timings. Where you intend to use the premises for the performance of live music at different times to those listed in the column on the left, please list</u> (please read guidance note 6)		
Fri					
Sat					
Sun					

F

Recorded music Standard days and timings (please read guidance note 7)			<u>Will the playing of recorded music take place indoors or outdoors or both – please tick</u> (please read guidance note 3)	Indoors	<input type="checkbox"/>
				Outdoors	<input type="checkbox"/>
				Both	<input type="checkbox"/>
Day	Start	Finish	<u>Please give further details here</u> (please read guidance note 4)		
Mon					
Tue			<u>State any seasonal variations for the playing of recorded music</u> (please read guidance note 5)		
Wed					
Thur					
Fri			<u>Non standard timings. Where you intend to use the premises for the playing of recorded music at different times to those listed in the column on the left, please list</u> (please read guidance note 6)		
Sat					
Sun					

G

Performances of dance Standard days and timings (please read guidance note 7)			<u>Will the performance of dance take place indoors or outdoors or both – please tick</u> (please read guidance note 3)	Indoors	<input type="checkbox"/>
Day	Start	Finish		Outdoors	<input type="checkbox"/>
Mon			<u>Please give further details here</u> (please read guidance note 4)	Both	<input type="checkbox"/>
Tue					
Wed			<u>State any seasonal variations for the performance of dance</u> (please read guidance note 5)		
Thur					
Fri			<u>Non standard timings. Where you intend to use the premises for the performance of dance at different times to those listed in the column on the left, please list</u> (please read guidance note 6)		
Sat					
Sun					

H

<p>Anything of a similar description to that falling within (e), (f) or (g) Standard days and timings (please read guidance note 7)</p>			<p>Please give a description of the type of entertainment you will be providing</p>		
Day	Start	Finish	<p><u>Will this entertainment take place indoors or outdoors or both - please tick</u> (please read guidance note 3)</p>	Indoors	<input type="checkbox"/>
Mon				Outdoors	<input type="checkbox"/>
				Both	<input type="checkbox"/>
Tue			<p><u>Please give further details here</u> (please read guidance note 4)</p>		
Wed					
Thur			<p><u>State any seasonal variations for entertainment of a similar description to that falling within (e), (f) or (g)</u> (please read guidance note 5)</p>		
Fri					
Sat			<p><u>Non standard timings. Where you intend to use the premises for the entertainment of a similar description to that falling within (e), (f) or (g) at different times to those listed in the column on the left, please list</u> (please read guidance note 6)</p>		
Sun					

1

Late night refreshment Standard days and timings (please read guidance note 7)			Will the provision of late night refreshment take place indoors or outdoors or both – please tick (please read guidance note 3)	Indoors	<input type="checkbox"/>
				Outdoors	<input type="checkbox"/>
				Both	<input type="checkbox"/>
Day	Start	Finish			
Mon			<u>Please give further details here</u> (please read guidance note 4)		
Tue					
Wed			<u>State any seasonal variations for the provision of late night refreshment!</u> (please read guidance note 5)		
Thur					
Fri			<u>Non standard timings. Where you intend to use the premises for the provision of late night refreshment at different times, to those listed in the column on the left, please list</u> (please read guidance note 6)		
Sat					
Sun					

J

Supply of alcohol Standard days and timings (please read guidance note 7)			Will the supply of alcohol be for consumption - please tick (please read guidance note 8)	On the premises	<input type="checkbox"/>			
				Off the premises	<input checked="" type="checkbox"/>			
				Both	<input type="checkbox"/>			
Day	Start	Finish	State any seasonal variations for the supply of alcohol (please read guidance note 5)					
Mon	08:00	23:30						
Tue	08:00	23:30						
Wed	08:00	23:30						
Thur	08:00	23:30				Non standard timings. Where you intend to use the premises for the supply of alcohol at different times to those listed in the column on the left, please list (please read guidance note 6)		
Fri	08:00	23:30						
Sat	08:00	23:00						
Sun	08:00	23:30						

State the name and details of the individual whom you wish to specify on the licence as designated premises supervisor (Please see declaration about the entitlement to work in the checklist at the end of the form):

Name	NAGALINGAM DHARMSIRI
Date of birth	[REDACTED]
Address	[REDACTED]
Postcode	[REDACTED]
Personal licence number (if known)	[REDACTED]
Issuing licensing authority (if known)	[REDACTED]

K

Please highlight any adult entertainment or services, activities, other entertainment or matters ancillary to the use of the premises that may give rise to concern in respect of children (please read guidance note 9).

L

<p>Hours premises are open to the public Standard days and timings (please read guidance note 7)</p>			<p><u>State any seasonal variations</u> (please read guidance note 5)</p>
Day	Start	Finish	<p><u>Non standard timings. Where you intend the premises to be open to the public at different times from those listed in the column on the left, please list</u> (please read guidance note 6)</p>
Mon			
Tue			
Wed			
Thur			
Fri			
Sat			
Sun			

M

Describe the steps you intend to take to promote the four licensing objectives:

a) General – all four licensing objectives (b, c, d and e) (please read guidance note 10)

- Following general rules to ensure that the four licensing objectives are promoted such as full training for all staff to ensure rules are followed such as challenge 25.

b) The prevention of crime and disorder

- Challenge 25
- Refusal register
- ID verification
- Zero drugs policy towards possession and supply of illegal drugs.

c) Public safety

- Challenge 25
- CCTV
- Five safety procedures according to regulations

d) The prevention of public nuisance

- Challenge 25
- CCTV
- If alcohol / cigarettes are consumed ^{immediately} outside the premises, we will request that they move away.

e) The protection of children from harm

- Challenge 25
- Alcohol and cigarettes out of children's reach
- ID verification
- Refusals register

Checklist:

Please tick to indicate agreement

- I have made or enclosed payment of the fee.
- I have enclosed the plan of the premises.
- I have sent copies of this application and the plan to responsible authorities and others where applicable.
- I have enclosed the consent form completed by the individual I wish to be designated premises supervisor, if applicable.
- I understand that I must now advertise my application.
- I understand that if I do not comply with the above requirements my application will be rejected.
- [Applicable to all individual applicants, including those in a partnership which is not a limited liability partnership, but not companies or limited liability partnerships] I have included documents demonstrating my entitlement to work in the United Kingdom or my share code issued by the Home Office online right to work checking service (please read note 15).

IT IS AN OFFENCE, UNDER SECTION 158 OF THE LICENSING ACT 2003, TO MAKE A FALSE STATEMENT IN OR IN CONNECTION WITH THIS APPLICATION. THOSE WHO MAKE A FALSE STATEMENT MAY BE LIABLE ON SUMMARY CONVICTION TO A FINE OF ANY AMOUNT.

IT IS AN OFFENCE UNDER SECTION 24B OF THE IMMIGRATION ACT 1971 FOR A PERSON TO WORK WHEN THEY KNOW, OR HAVE REASONABLE CAUSE TO BELIEVE, THAT THEY ARE DISQUALIFIED FROM DOING SO BY REASON OF THEIR IMMIGRATION STATUS. THOSE WHO EMPLOY AN ADULT WITHOUT LEAVE OR WHO IS SUBJECT TO CONDITIONS AS TO EMPLOYMENT WILL BE LIABLE TO A CIVIL PENALTY UNDER SECTION 15 OF THE IMMIGRATION, ASYLUM AND NATIONALITY ACT 2006 AND PURSUANT TO SECTION 21 OF THE SAME ACT, WILL BE COMMITTING AN OFFENCE WHERE THEY DO SO IN THE KNOWLEDGE, OR WITH REASONABLE CAUSE TO BELIEVE, THAT THE EMPLOYEE IS DISQUALIFIED.

Part 4 - Signatures (please read guidance note 11)

Signature of applicant or applicant's solicitor or other duly authorised agent (see guidance note 12). **If signing on behalf of the applicant, please state in what capacity.**

Declaration	<ul style="list-style-type: none"> • [Applicable to individual applicants only, including those in a partnership which is not a limited liability partnership] I understand I am not entitled to be issued with a licence if I do not have the entitlement to live and work in the UK (or if I am subject to a condition preventing me from doing work relating to the carrying on of a licensable activity) and that my licence will become invalid if I cease to be entitled to live and work in the UK (please read guidance note 15). • The DPS named in this application form is entitled to work in the UK (and is not subject to conditions preventing him or her from doing work relating to a licensable activity) and I have seen a copy of his or her
-------------	--

	proof of entitlement to work, or have conducted an online right to work check using the Home Office online right to work checking service which confirmed their right to work (please see note 15)
Signature	
Date	01 - 08 - 2019
Capacity	LEASEHOLDER

For joint applications, signature of 2nd applicant or 2nd applicant's solicitor or other authorised agent (please read guidance note 13). If signing on behalf of the applicant, please state in what capacity.

Signature	
Date	
Capacity	

Contact name (where not previously given) and postal address for correspondence associated with this application (please read guidance note 14)			
Post town		Postcode	
Telephone number (if any)			
If you would prefer us to correspond with you by e-mail, your e-mail address (optional)			

Appendix 2

The application relates to the sale of alcohol

	Sale of Alcohol (Off the premises only)			
	Existing		Proposed	
	From	To	From	To
Monday	N/A	N/A	08 00	23 00
Tuesday	N/A	N/A	08 00	23 00
Wednesday	N/A	N/A	08 00	23 00
Thursday	N/A	N/A	08 00	23 00
Friday	N/A	N/A	08 00	23 00
Saturday	N/A	N/A	08 00	23 00
Sunday	N/A	N/A	08 00	22 30

	Open to the Public			
	Existing		Proposed	
	From	To	From	To
Monday	N/A	N/A	06 00	23 00
Tuesday	N/A	N/A	06 00	23 00
Wednesday	N/A	N/A	06 00	23 00
Thursday	N/A	N/A	06 00	23 00
Friday	N/A	N/A	06 00	23 00
Saturday	N/A	N/A	06 00	23 00
Sunday	N/A	N/A	06 00	22 30

Ashton, Kerryann

From: Hooper Trevor (Licensing) <Trevor.Hooper@thamesvalley.pnn.police.uk>
Sent: 14 August 2019 14:16
To: Ashton, Kerryann
Subject: FW: Re:

KA Kugan has agreed the hours set out in my email.

Regards

Trevor

Trevor Hooper | Aylesbury & Chiltern Licensing Officer | Telephone **01865 85 4197** | Internal **311 6034** | Email trevor.hooper@thamesvalley.pnn.police.uk

Address **Licensing, Aylesbury Police Station, Wendover Road, Aylesbury, Bucks, HP21 7LA.**

The new Crime Prevention Toolkits are now available on the intranet at:

<http://knowzone/kz-prev-homepage.htm>

For information, guidance and the Licensing Toolkit, visit: <http://knowzone/kz-lic-homepage.htm>

*
From: Sabaratnam Kuganathan [redacted]
Sent: 14 August 2019 14:06
To: Hooper Trevor (Licensing) <Trevor.Hooper@thamesvalley.pnn.police.uk>
Subject: Re:

Dear Trevor,

I am happy to confirm the timings to remain the same as stated above.

Thank you,

Kugan

On Tue, Aug 13, 2019 at 7:16 AM Hooper Trevor (Licensing) <Trevor.Hooper@thamesvalley.pnn.police.uk> wrote:

Dear sir,

I have now had chance to look at your application for a premises licence (Off sales)

I note that the premises has in the past been subject to a licence with closing hours Monday to Saturday 2300 and 2230 on Sundays.

In line with the policy for this area the police will not object to this application if the hours applied for remain the same as above. I.e Monday to Saturday 2300 and 2230 on Sundays.

Regards

Trevor

Trevor Hooper | Aylesbury & Chiltern Licensing Officer | Telephone **01865 85 4197** | Internal **311 6034**
| Email trevor.hooper@thamesvalley.pnn.police.uk

Address **Licensing, Aylesbury Police Station, Wendover Road, Aylesbury, Bucks, HP21 7LA.**

The new Crime Prevention Toolkits are now available on the intranet at:

<http://knowzone/kz-prev-homepage.htm>

For information, guidance and the Licensing Toolkit, visit: <http://knowzone/kz-lic-homepage.htm>

Thames Valley Police currently use the Microsoft Office 2007 suite of applications. Please be aware of this if you intend to include an attachment with your email. This communication contains information which is confidential and may also be privileged. Any views or opinions expressed are those of the originator and not necessarily those of Thames Valley Police. It is for the exclusive use of the addressee(s). If you are not the intended recipient(s) please note that any form of distribution, copying or use of this communication or the information in it is strictly prohibited and may be unlawful. If you have received this communication in error please forward a copy to: informationsecurity@thamesvalley.pnn.police.uk and to the sender. Please then delete the e-mail and destroy any copies of it. Thank you.

This email has been scanned by the Symantec Email Security.cloud service.
For more information please visit <http://www.symanteccloud.com>



Licensing officer
Environmental Health and Licensing
Aylesbury Vale District Council
The Gateway
Gatehouse Road
Aylesbury
HP19 8FF

19 August 2019

Subject: Request to re-evaluate the demand of licence for 181 Cambridge street, Aylesbury, HP20 1BQ.

Respected Sir,

I would like to draw your kind attention for not issuing licence to Mr. S. Kuganathan at 181 Cambridge street, Aylesbury, HP20 1BQ

I am the resident of [redacted] Sir, this is a residential area. I and my all neighbours are living here with families and children. The demanded licence is to open the shop till 11:30pm will disturb my family. It maybe be harmful to our peaceful life in future. I do not want my children exposed to abusive behaviour late at night. Moreover there are more than enough off licence alcohol shops in this area and because of that there were some violence incidents happened in past.

So please Sir, it is my humble request to rethink about issuing licence to 181 Cambridge street, Aylesbury, HP20 1BQ. My oppose against the above said purpose is in favour of humility, in favour of to maintain law and order and ofcourse in favour of social justice.

Kind Regards,



AYLESBURY VALE
DISTRICT COUNCIL
27 AUG 2019
RECEIVED
ENVIRONMENTAL HEALTH & LICENSING SERVICES

2

Licensing Officer
Environmental Health and Licensing
Aylesbury Vale District Council
The Gateway
Gatehouse Road
Aylesbury
Buckinghamshire
HP19 8FF



15th August 2019

To: AVDC Licensing Council

Subject: Request to rethink the licensing for 181
Cambridge Street, Aylesbury, HP20 1BQ

I'm the resident of [redacted]
[redacted]

I am emailing regarding the application Sabaratnam
Kuganathan at 181 Cambridge Street, Aylesbury, HP20
1BQ has put forward for premises licence.

I would like to oppose this application put forward as this
is a residential area and a shop being open till 11:30pm
will cause public nuisance. The noise from drunken
people outside will disturb my family and children.

I hope this is taken into thought when making a decision.

Kind Regards,



AYLESBURY VALE
DISTRICT COUNCIL
27 AUG 2019
RECEIVED
ENVIRONMENTAL HEALTH & LICENSING SERVICES

3

Licensing Officer
Environmental Health and Licensing
Aylesbury Vale District Council
The Gateway
Gatehouse Road
Aylesbury
Buckinghamshire
HP19 8FF



14th August 2019

To: AVDC Licensing Council

Subject: Request to rethink the licensing for 181
Cambridge Street, Aylesbury, HP20 1BQ

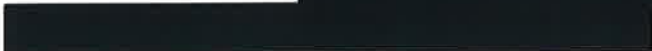
I'm the resident of 
 I am emailing
regarding the application Sabaratnam Kugananthan at
181 Cambridge Street, Aylesbury, HP20 1BQ has put
forward for premises licence.

AYLESBURY VALE
DISTRICT COUNCIL
20 AUG 2019

I would like to oppose this application Mr Kugananthan
has put forward, A shop being open till 11:30pm it will
disturb my family and the local residence, and potentially
drunken people will put other residence at risk.

RECEIVED
ENVIRONMENTAL HEALTH & LICENSING SERVICES

I look forward to hearing from you soon,

Kind Regards,



ea

Licensing Officer
Environmental Health and Licensing
Aylesbury Vale District Council
The Gateway
Gatehouse Road
Aylesbury
Buckinghamshire
HP19 8FF



14th August 2019

To: AVDC Licensing Council

Subject: Request to rethink the licensing for 181
Cambridge Street, Aylesbury, HP20 1BQ

I'm the resident of 

I am emailing regarding the application Sabaratnam
Kugananthan at 181 Cambridge Street, Aylesbury, HP20
1BQ has put forward for premises licence.

I would like to oppose this application put forward as this
is a residential area and a shop being open till 11:30pm
will disturb my family, an aspect that no resident should
have to deal with. Alcoholic people staying up till late
being a nuisance will also be very disturbing.

Please take these factors into consideration when making
your decision.

I look forward to hearing from you soon,

Kind Regards,

5

Licensing Officer
Environmental Health and Licensing
Aylesbury Vale District Council
The Gateway
Gatehouse Road
Aylesbury
Buckinghamshire
HP19 8FF



14th August 2019

To: AVDC Licensing Council

Subject: Request to rethink the licensing for 181
Cambridge Street, Aylesbury, HP20 1BQ

I'm the resident of [redacted]
[redacted] I am emailing
regarding the application Sabaratnam Kuganathan at
181 Cambridge Street, Aylesbury, HP20 1BQ has put
forward for premises licence.

I would like to oppose the application put forward as this
is a residential area and a shop being open till 11:30pm
will disturb my family and having young children it
would potentially put my children at risk. I do not want
my children exposed to abusive behaviour late at night.

Please take these factors into consideration when making
your decision.

I look forward to hearing from you soon,

Kind Regards,

[redacted]
[redacted]



Licensing Officer
Environmental Health and Licensing
Aylesbury Vale District Council
The Gateway
Gatehouse Road
Aylesbury
Buckinghamshire
HP19 8FF

TO: AVDC Licensing Council

Subject: Request to rethink the licensing for 181 Cambridge street, Aylesbury,HP20 1BQ.

Respected officer,

As I have come to know that in a very near future, a person named Sabaratnam Kuganathan who has applied to Aylesbury Vale council for giving permission/ Licensing for convenience store and off licence alcohol shop to 181 Cambridge street, Aylesbury,HP20 1BQ. Which is residential area. Where so many families living including me.

My address is above and I would like to oppose the application put forward as this is a residential area and shop being open till 1130pm will disturb here's family environment. And having young children and teenagers it would potentially put them at risk. Some alcoholic people will stay here up to late night and will do some unhygienic activities towards the society .I do not want these will be an adverse effect on our kids which is very dangerous to our lives.

Sir, we living here peacefully. In future situations will not go out of control and our lives will not put in risk because of violence, it is my request to rethink over the Licensing for 181 Cambridge street, Aylesbury,HP20 1BQ. Please take these factors into consideration when making your decision. I hope for a favorable action.

Thank you.
Kind Regards,



Licensing Officer
Environmental Health and Licensing
Aylesbury Vale District Council
The Gateway
Gatehouse Road
Aylesbury
Buckinghamshire
HP19 8FF



14th August 2019

To: AVDC Licensing Council

Subject: Request to rethink the licensing for 181
Cambridge Street, Aylesbury, HP20 1BQ

I'm the resident of [redacted]
[redacted]

I am emailing regarding the application Sabaratnam
Kuganathan at 181 Cambridge Street, Aylesbury, HP20
1BQ has put forward for premises licence.

I would like to oppose this application put forward as this
is a residential area and a shop being open till 11:30pm
will disturb my family, an aspect that no resident should
have to deal with. Alcoholic people staying up till late
being a nuisance will also be very disturbing.

Please take these factors into consideration when making
your decision.

I look forward to hearing from you soon,

Kind Regards,

[redacted signature block]

AYLESBURY VALE
DISTRICT COUNCIL
20 AUG 2019
[redacted stamp details]

8

Licensing Officer
Environmental Health and Licensing
Aylesbury Vale District Council
The Gateway
Gatehouse Road
Aylesbury
Buckinghamshire
HP19 8FF

Date: 17/08/2019

To, AVDC Licensing Council

Subject: Licensing for 181 Cambridge Street, Aylesbury HP20 1BQ

I, 
would like to raise objection on the application for Off Licence for **Mr. Sabaratnam Kuganathan 181 Cambridge Street, Aylesbury HP20 1BQ.**

We fear that it will be more noisy in the area as shop will be open till late. There is also potential risk for troubles with local community while people get drunk. That's why I strongly oppose issuance of this Licence.

Thanks

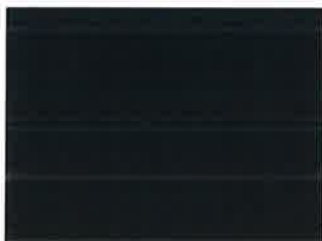

AYLESBURY VALE
DISTRICT COUNCIL
20 AUG 2019
RECEIVED
ENVIRONMENTAL HEALTH & LICENSING SERVICE

9

From: [REDACTED]
To: Licensing Mailbox
Subject: Request to think on giving permission for license to open a convenience store and off licence alcohol shop .
Date: 07 August 2019 16:35:34

Respected Sir,
(Licensing Services Manager)

With reference to above subject I have potential opposed for giving licence or accepting application on convenience store and off licence shops at 181CAMBRIDG STREET, AYLESBURY. HP20 1BQ.

As I have come to know that in very near future a convenience store and off licence sale of alcohol between 08:00 to 23:30 (Monday - Sunday) on 181 cambridge street, sir this is a residential area where families lives with kids including me. I afraid that due to the proposed shop of wine, obviously costumer who need badly alcohol stay here up to late night. And some bad or violent of them will might do some unhygienic activities towards the society... that's the possibility because of some accidents were happened in the street. There were also some violence cases happened in the street.

Moreover there are so many off licence alcohol shops in the small area street like ALDI, LIDL, B&M, BELLA CAFFE, RHEA NEWS, ONE ROMANIAN SHOP AND ALSO ONE PUB. Which already sales alcohol. So might be in future situations gone out of law or violence I have clearly opposed on giving licence to this shop. I have one little daughter so I can understand the value of peace. That's why it's my humble request to you, Sir to think on giving or allowance to this shop at 181 CAMBRIDGE STREET, AYLESBURY. HP20 1BQ.

Thank you.
Your Faithfully,

[REDACTED]

[REDACTED]

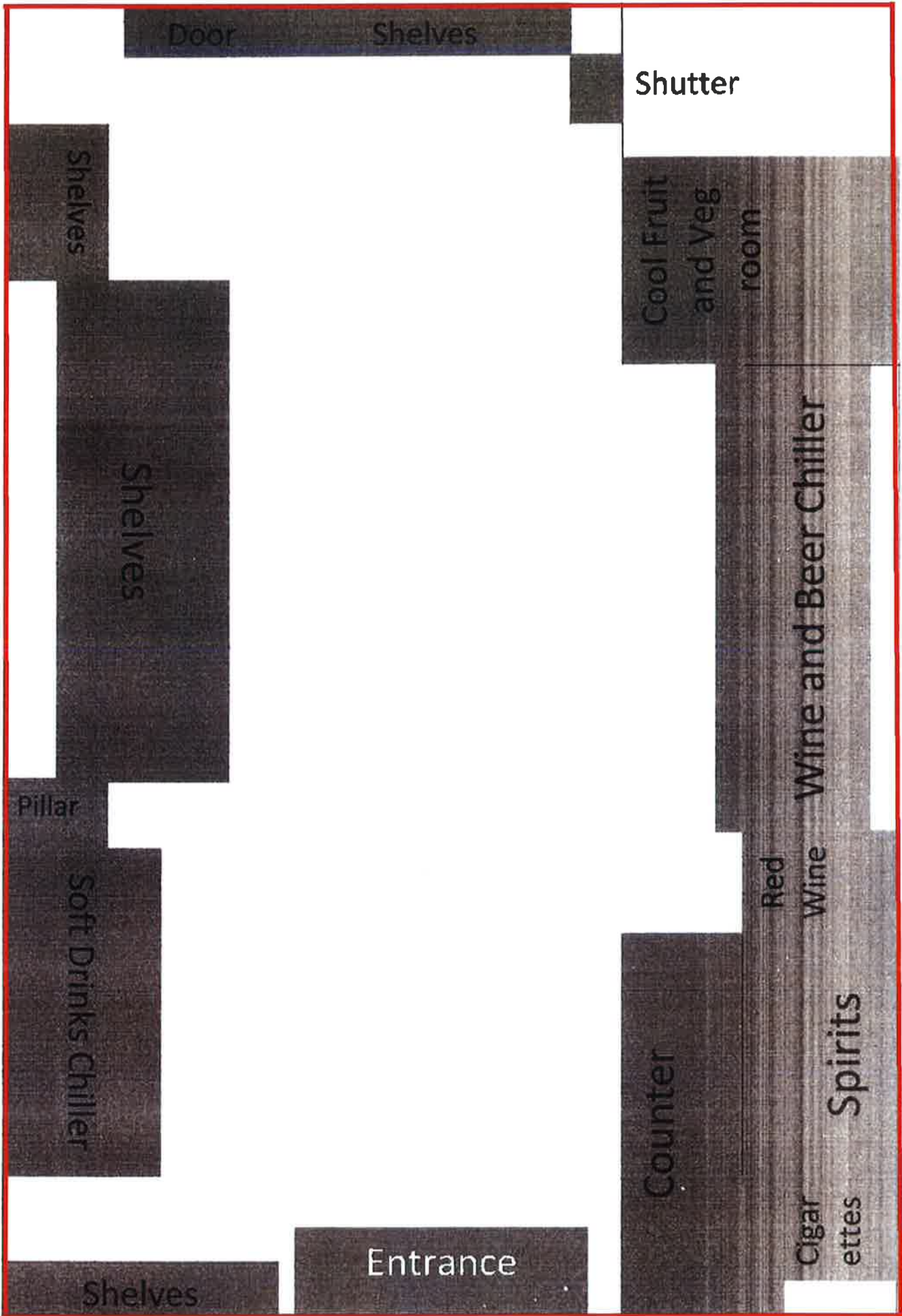

181 Cambridge Street, Aylesbury



11/09/2019, 10:13:46

1:1,250
0 0.01 0.02 0.03 0.04 mi
0 0.01 0.02 0.03 0.04 km
Ordnance Survey data © Crown copyright and database right 2019. OS 100030994.